

CHECK VALVE

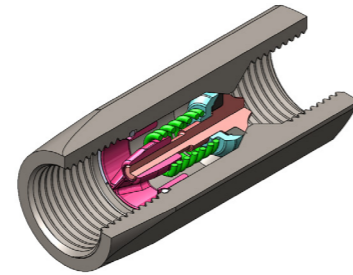

[CLICK HERE FOR 3D SECTION](#)

TECHNICAL FEATURES AND OPTIONS



Working Temperature
-20 °C / +80 °C



Flow Rate
Up to 750 l / min



Material
Carbon Steel
Stainless Steel



Operating Pressure
Up to 250 Bar



Available Threads
BSP - NPT - SAE



Available Sizes
From 1/4" to 2"



Sealing Description
NBR - FKM

MAIN APPLICATIONS



INFORMATION

- OLEOCON Check Valves can be used to prevent flow in one direction or to produce a backpressure in the system. They can also be connected to the system as a by-pass of another system component.
- OLEOCON Check Valves have a cracking pressure of 0.5 Bar, but it can be customised upon request.
- Compact and slim design.
- Easy-to-use.

WARNING

- Please do not expose to abnormal operating conditions. (E.g. oscillations, impulse pressures, water hammering, cavitation, and proportions of solid materials and abrasives)
- Please do not touch the valve, when the working temperature is lower than -20°C or higher than +50°C.
- Make sure the system pressure is below the maximum working pressure.
- Please ensure the cleanliness of all connection surfaces to avoid dirt or dust accumulation in the circuit.
- Please ensure the alignment and full connection of the assembly parts.
- Please ensure that the OLEOCON product you have chosen is compatible with the temperature, material and pressure requirements of your system.
- Please contact OLEOCON technical support for any further questions.

TECHNICAL DRAWING

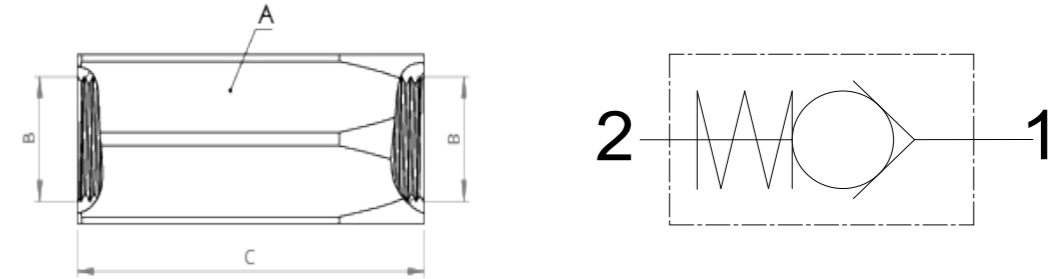

BODY SIZE	DESCRIPTION	Hex		THREAD SIZE(B)	LENGTH	WEIGHT	
		mm	inch			mm	inch
6.3	CV-6-G14	A 19	0,74	1/4"	C 57	2,24	0,15 0,33
10	CV-10-G38	A 24	0,94	3/8"	C 58	2,28	0,16 0,35
12.5	CV-12-G12	A 30	1,18	1/2"	C 69	2,71	0,27 0,59
20	CV-20-G34	A 38	1,49	3/4"	C 83	3,26	0,49 1,07
25	CV-25-G1	A 46	1,81	1"	C 99,2	3,90	0,75 1,65
31.5	CV-31-G114	A 55	2,16	1 1/4"	C 117,2	4,61	1,31 2,88
40	CV-40-G112	A 70	2,75	1 1/2"	C 134,2	5,28	2,66 5,85
50	CV-50-G2	A 80	3,14	2"	C 160,2	6,30	3,89 8,55

ISO 1179-1

BODY SIZE	DESCRIPTION	Hex		THREAD SIZE(B)	LENGTH	WEIGHT	
		mm	inch			mm	inch
6.3	CV-6-NPT14	A 19	0,74	1/4"	C 57	2,24	0,15 0,33
10	CV-10-NPT38	A 24	0,94	3/8"	C 58	2,28	0,16 0,35
12.5	CV-12-NPT12	A 30	1,18	1/2"	C 69	2,71	0,27 0,59
20	CV-20-NPT34	A 38	1,49	3/4"	C 83	3,26	0,49 1,07
25	CV-25-NPT1	A 46	1,81	1"	C 99,2	3,90	0,75 1,65
31.5	CV-31-NPT114	A 55	2,16	1 1/4"	C 117,2	4,61	1,31 2,88
40	CV-40-NPT112	A 70	2,75	1 1/2"	C 134,2	5,28	2,66 5,85
50	CV-50-NPT2	A 80	3,14	2"	C 160,2	6,30	3,89 8,55

ASMEB1.20.1NPT

BODY SIZE	DESCRIPTION	Hex		THREAD SIZE(B)	LENGTH	WEIGHT	
		mm	inch			mm	inch
6.3	CV-6-SAE4	A 19	0,74	7/16 UNF	C 57	2,24	0,15 0,33
10	CV-10-SAE6	A 24	0,94	9/16 UNF	C 58	2,28	0,16 0,35
12.5	CV-12-SAE 8	A 30	1,18	3/4 UNF	C 69	2,71	0,27 0,59
20	CV-20-SAE12	A 38	1,49	1 1/16 UN	C 83	3,26	0,49 1,07
25	CV-25-SAE16	A 46	1,81	1 5/16 UN	C 99,2	3,90	0,75 1,65
31.5	CV-31-SAE20	A 55	2,16	1 5/8 UN	C 117,2	4,61	1,31 2,88
40	CV-40-SAE24	A 70	2,75	1 7/8 UN	C 134,2	5,28	2,66 5,85
50	CV-50-SAE32	A 80	3,14	2 1/2 UN	C 160,2	6,30	3,89 8,55

ISO 11926-1